

PIVOT PIN TOOL FOR AR10*

THE FASTEST WAY TO INSTALL YOUR AR10 PIVOT PIN.

How can such a small task cause such frustration? The Pivot Pin Tool for AR10 gives you a third hand to turn the fumble-finger, pin-launching, pain-in-the-neck task into a quick breeze. 1-2-3-4 done, it's that simple. Easily install the AR10 Pivot Pin in less than 60 seconds.



1-2-3-4 DONE, IT'S THAT EASY

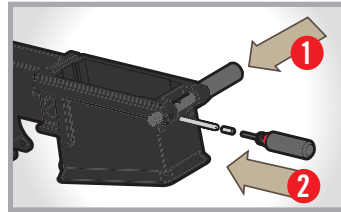

Step 1. Slide the Pivot Pin Tool (PPT) fixture into the pin housing on the lower and load spring first then detent second, followed by Detent Plunger Tool (DPT).

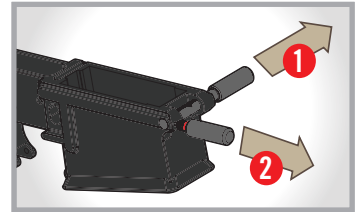

Step 2. Once spring and detent are compressed, slowly slide the PPT fixture away from DPT, locking the detent and spring in place and remove DPT.

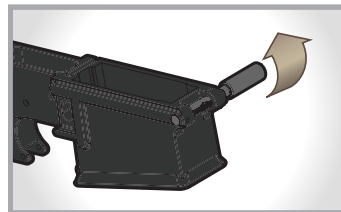

Step 3. Rotate the PPT assembly 90 degrees.

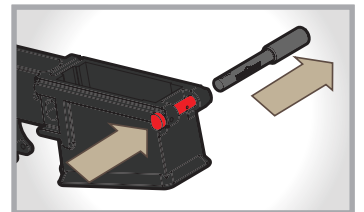

Step 4. Insert pivot pin as shown, until the detent snaps into place. Finally, remove the PPT from receiver and push the pivot pin into the closed position.

NOT COMPATIBLE WITH AR10B



***DISCLAIMER:** This product is not manufactured, authorized, endorsed, or warranted by ArmaLite, Inc. ArmaLite, Inc. does not warrant or represent that this product is compatible with AR-10. "AR-10" is a federally registered trademark of ArmaLite, Inc. New Revo Brand Group, LLC, d/b/a Real Avid is not affiliated in any manner with, or otherwise endorsed by ArmaLite, Inc.

WARNING: This product can expose you to chemicals including Nickel (Metallic), which is known to the State of California to cause cancer. For more information, go to www.P65Warnings.ca.gov.



5480 NATHAN LANE NORTH, SUITE 120
MINNEAPOLIS, MN 55442 800.286.0567
info@realavid.com | RealAvid.com
© 2023 NEW REVO BRAND GROUP, LLC.

